

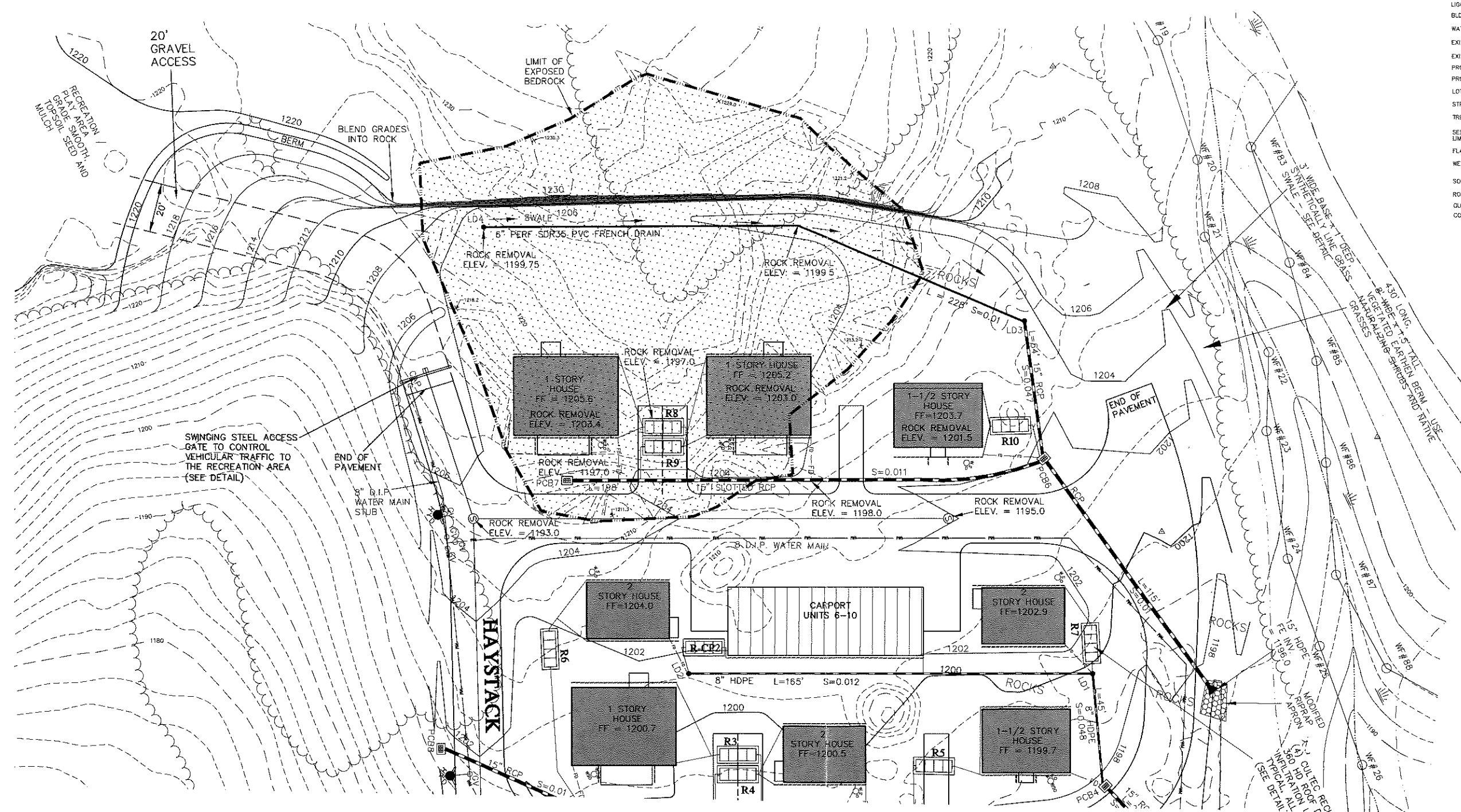

NOTE:
 REMOVE BEDROCK IN DEVELOPED AREAS TO:
 - TWO FEET MINIMUM BELOW PROPOSED FINISHED GRADE
 - TWO FEET MINIMUM BELOW MINIMUM FINISHED FLOOR ELEVATION OF PROPOSED RESIDENCES
 - ONE FOOT MINIMUM BELOW CATCH BASIN, MANHOLE AND CONCRETE UTILITY STRUCTURES
 - ONE FOOT MINIMUM BELOW ALL PIPING AND CONDUITS
 - TWO FEET BELOW THE BOTTOM OF ROOF LEADER INFILTRATION UNITS.

LEGEND

PROPERTY LINE	---
EXISTING MONUMENT	□
EXISTING IRON PIN OR PIPE	○
PROPOSED IRON PIN OR PIPE	●
PROPOSED MONUMENT	■
DRILL HOLE	⊕
STONE BOUND	⌞
UTILITY POLE W/ANCHOR	⊕
EASEMENT LINE	- - - - -
CHAIN FENCE	— o — o —
WOOD FENCE	— // // —
STONE WALL	— x x x —
WIRE FENCE	— x — x —
CATCH BASIN	⊕
LIGHT POLE	⊕
BLDG. SETBACK LINE	— x —
WATERCOURSE	— ~ —
EXISTING CONTOUR	— 310 —
EXISTING SPOT ELEVATION	311.5
PROPOSED CONTOUR	— 310 —
PROPOSED SPOT ELEVATION	311+5
LOT NUMBER	①
STREET NUMBER	55
TREE LINE	— () —
SEDIMENT FENCE / LIMIT OF CONSTRUCTION	— GSF —
FLAGGED WETLANDS	— W 1 —
WETLANDS	— W —
SOIL BOUNDARY	— (R2) —
ROCK OUTCROP	— (R) —
GUIDE RAIL	— — — — —
CONTRACT / CLEARING LIMITS	— — — — —



**ROCK REMOVAL PLAN
 ADDENDUM 4**

PREPARED FOR
**FOUNDATION FOR
 NORFOLK LIVING, INC.**
 OLD COLONY ROAD
 NORFOLK, CONNECTICUT

Hrica Associates LLC
 Engineers Surveyors

Kenneth S. Hrica, P.E., P.L.S.
 44 Maple View Trail
 P.O. Box 1681
 Litchfield, Connecticut 06759

860-567-2112 (business)
 860-567-0491 (local/cell)
 e-mail: hricassoc@optonline.net

DATE: 05/01/2023 MAP #: 0723
 SCALE: 1"=40 ft. SHEET #: 1 OF 1
 DRAWING: 180723 DRAWN BY: TJS
 PROJECT #: 18-0723 CHECKED BY: KSH

Not valid without original seal